

JA-121PB Bus combined motion and glass-break detector

type: 1PIRBS2305MU

The product is a component of JABLOTRON system. It is used for human movement detection in the interior of buildings and for detection of breakage of glass surfaces forming the building. It contains two independent detectors (it occupies 2 positions in the control panel). It uses a PIR detector to detect the movement of people and a GBS detector to detect the breakage of glass surfaces. The GBS alarm is evaluated based on changes in air pressure and the characteristic sounds of glass breaking. The detector is designed to be installed by a trained technician with a valid Jablotron certificate.

Installation



Always switch the power off before connecting the detector to the bus.

During the installation pay attention that there should be no obstacles in the detector's view, such as:

- items that change temperature quickly (electric stove, gas appliances etc.)
- objects that move (e.g. waving curtains over the heating, robotic vacuum cleaner)
- no obstacles obstructing the view of the protected area
- moving pets

We do not recommend installing the detector:

- against windows or spotlights
- in places where air flows (ventilation, air conditioning, vents, leaky doors etc.)
- near air outlets, fans, or other sources of air pressure changes or intense sounds
- in a protected area where there are sources of vibration or shock

Installation procedure:

1. Open the cover of detector by using the latch (4). Do not touch the PIR sensor inside (12) – it could be damaged.
2. Release the PCB located in the rear cover by pressing the latch (7) at the top of the cover.
3. In the rear part, break out the cover for bus cable. Recommended installation height is 2.2–2.5 m above the floor level.
4. Push the BUS cable through the plastic base and attach it to the selected place (vertically, cover latch down).
5. Insert into the rear plastic of the PCB detector using the electronics latch (7) and connect cable wires to the terminals.
6. Close the detector cover, snap into the cover latch (4) and secure with the locking screw.

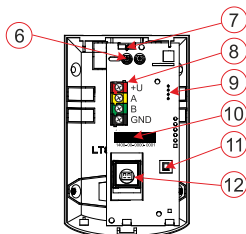
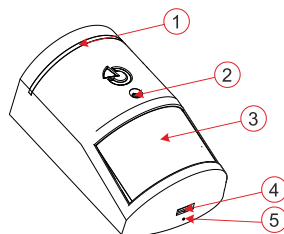

- 1 – LED indicator
- 2 – GB sensor
- 3 – PIR lens
- 4 – cover latch
- 5 – hole for locking screw
- 6 – LED diode
- 7 – PCB latch
- 8 – Bus terminals
- 9 – connector for GBS module
- 10 – serial number
- 11 – tamper
- 12 – PIR sensor

Fig. 1: Description of the external and internal parts of product

Enrollment to the system and settings

Depending on the type of control panel, use the recommended software or application, see the control panel manual.

Technical specification

Power.....	from control panel bus 12 V DC (8–15 V)
Quiescent current consumption	4.2 mA
Maximal current consumption	40 mA
Recommended installation height	2.2–2.5 m
Detection angle/coverage (PIR)	110°/12 m
Detection angle/coverage (GBS)	90°/9 m
Detection type.....	acoustic
Dimensions	60 x 98 x 52 mm
Weight.....	81 g

type: 1PIRBS2305MU

Classification	security grade 2/environmental class II (according to EN 50131-1)
Environment.....	indoor general
Operating temperature range	–10 °C to +40 °C
Average operating humidity	75% RH, non-condensing
Certification body	Trezor Test (no. 3025)
In compliance with.....	EN IEC 63000, EN 50130-4, EN 55032, EN 50131-1, EN 50131-2-2, EN 501312-7-1
Recommended screw.....	2 x ø 3.5 x 40 mm (countersunk head)



JABLOTRON a.s. hereby declares that the 1PIRBS2305MU product is in a compliance with the relevant Union harmonisation legislation: Directives No.: 2014/53/EU, 2014/35/EU, 2014/30/EU, 2011/65/EU, if it is used as intended. The original of the conformity assessment can be found at www.jablotron.com Section Downloads.



Note: Disposing of this product correctly will help save valuable resources and prevent any potential negative effects on human health and the environment, which could otherwise arise from inappropriate waste handling. Please return the product to the dealer or contact your local authority for further details of your nearest designated collection point.

For an electronic version of this document (available in other languages) or an installation version in JA-100, scan the attached QR code: <https://manuals.jablotron.com/ja-121pb>.



JABLOTRON